

1425-1427 Toorak Road CAMBERWELL VIC

- Land: 250m2 approx.
- Buildings: 121m2 approx.
- Return: \$44,000 (plus GST/outgoings)
- Toorak Road exposure
- Rear access with space for 4 cars

Outstanding location amongst the vibrant and bustling Burwood Village with tram at front door.

Building Size : 121 sqm
Land Size : 250 sqm
View : <https://www.jacain.com.au/sale/vic/east/camberwell/commercial/other/7490961>



Chris Cain
03 9805 2900

1425-1427 Toorak Road Camberwell

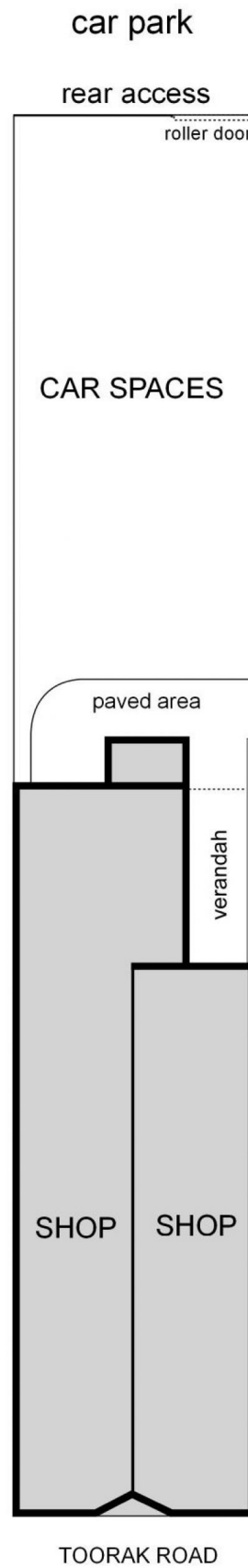
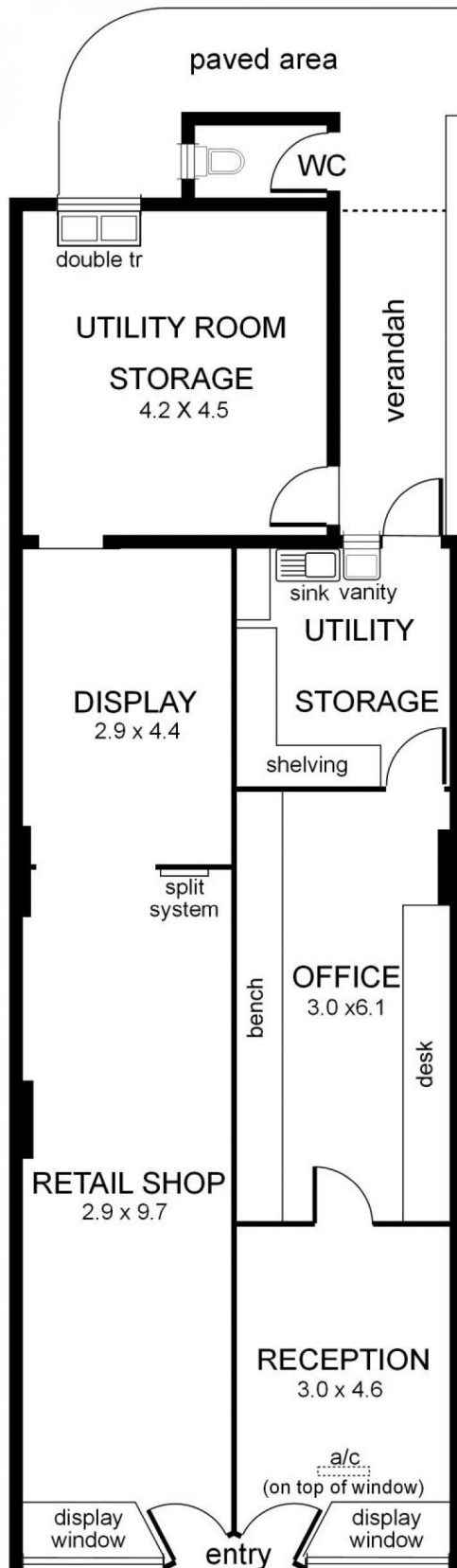

0 1 2 3 4 5 mts.

approx. scale



NB: All possible care is taken with measurements
however it should be assumed that they are
approximations and are not definitive

This plan is a guide only, not a detailed specification

Particulars herein are for information only and do not constitute representation by the Owner or Agent